

**Step #8 - Attach Tubing To Garden Hose Connector.** Fully insert the other end of the tubing into the garden hose connector. Push and pull the tubing to ensure that it has been installed properly and has clicked into place.

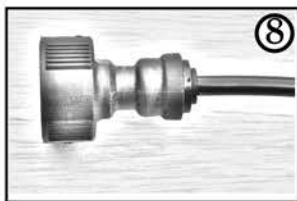

**Step #9 - Attach To “Drink Safe” Garden Hose & Fill.** Attach the garden hose connector to an outside spigot or to a hose that is labeled as “drink safe,” “lead free,” or “safe for potable water.” Turn on the water. When the tank is half full, tilt it forward to drive out any air trapped inside the BriteTap (see BriteTap User Guide steps #3 & #4.) Tilt back and let the tank continue filling.



**WARNING - STANDARD GARDEN HOSES CONTAIN LEAD & OTHER TOXINS THAT ARE DANGEROUS TO CHICKENS AND TO YOU IF YOU EAT THEIR MEAT OR EGGS. ONLY USE HOSES LABELED AS SAFE FOR DRINKING.**

Drink safe hoses are available at hardware and home improvement stores, RV & camping stores, boat & marine stores, and Amazon.com.

## Trouble Shooting

### Water Tank Overflows

If this is your first time using the Auto-Filler, check that you have properly positioned the valve inside the tank (see step #4). The arm of the valve should be positioned so that it is closest to the tank wall. If the Auto-fill is properly installed, adjust the float to lower the water level (see below)

### Water Level Too High or Too Low

To adjust the water level inside your tank, loosen the wing nut and either raise or lower the float and re-tighten the wing nut. The tank will be at maximum fill when the float is parallel to the ground.

### Hot & Cold Weather

The water inside the Auto-Filler will freeze when the temperature dips below 32° Fahrenheit (0° C). During cold weather, you will need to switch back to manually filling your chicken waterer. During the summer, try to place the garden hose in the shade to keep fill water cool.

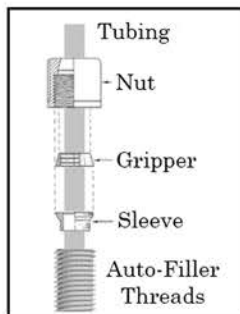

**Compression Fitting Parts**  
Inside the compression nut is a plastic sleeve and gripper.

If you remove the nut, make sure to re-install the parts in the direction and order shown.

# BriteTap™ Auto-Filler

## Safety & Set Up Manual

- A - Garden Hose Connector
- B - Tubing
- C - Valve Assembly
- D - Compression Nut
- E - Threaded Connector
- F - Hex Nut
- G - Rubber Gasket
- H - Water Outlet
- I - Wing Nut
- J - Float Arm
- K - Float

Requires a “Drink Safe” garden hose (not included)

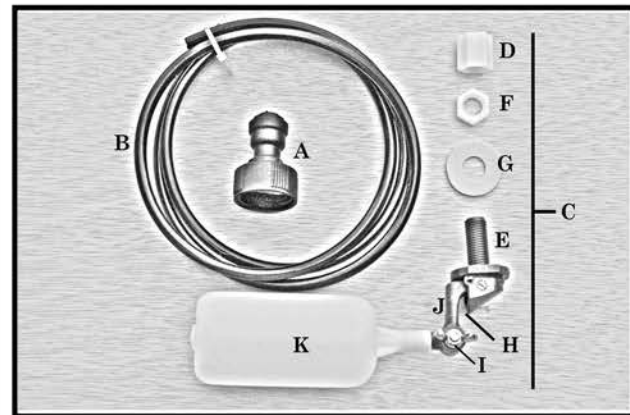

## Video Set-Up Instructions

To see a video of how to set up your new Auto-Filler, scan this QR barcode with your smart phone or visit:



[www.vimeo.com/chickenwaterer/auto-filler-set-up](http://www.vimeo.com/chickenwaterer/auto-filler-set-up)



### Set-Up

**Step #1- Mark a Drill Hole Location.** Mark a spot on the container lid that's at least 1.25" (3.5 cm) from the edge of the container. For 2-gallon Rubbermaid® brand coolers make drill hole in one of the lid depressions.

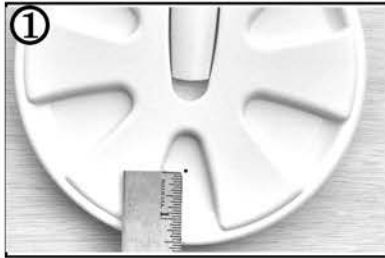

**Step #2 - Drill Hole.** Using an electric drill, make a 7/16" hole (11 mm) in the location you just marked.

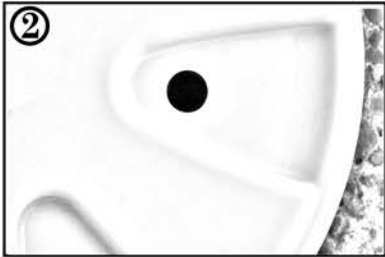

**Step #3 - Insert Auto-Filler & Gasket.** Place the gasket on the threaded section of the Auto-Filler and insert through the hole so that the body of the valve will be positioned inside your water supply tank and the threaded section is poking through the top of the lid.

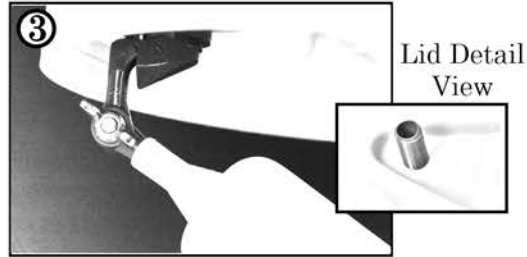

**Step #4 - Position Auto-Filler.** Position the Auto-Filler so that the arm is located closest to the edge of the lid and the float pointing to the center.

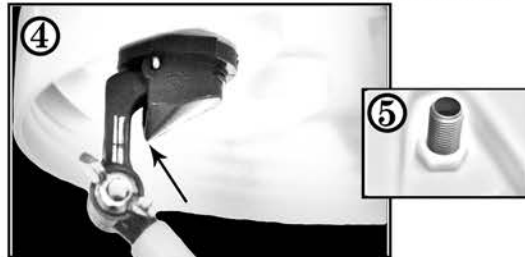

**Step #5 - Attach Auto-Filler.** Attach the Auto-Filler to the lid by screwing the plastic hex nut onto the threaded section of the Auto-Filler. Make sure that the nut is tight enough that the auto-filler won't easily rotate and cause the float to come into contact with the wall or your water tank. This could prevent proper functioning of the Auto-Filler.

**Step #6 - Adjust Float.** Loosen the wing nut on the float arm and position the float so that the main section of the float is closest to the center of the tank. Retighten wing nut. Note: Once you've completed assembly, you have the option to change the angle of the float. This controls fill level.

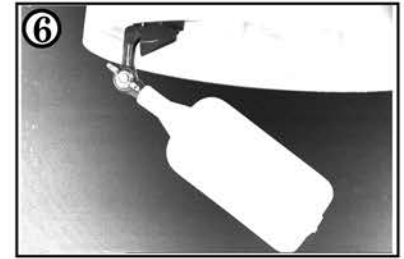

**Step #7 - Attach Tubing To Auto-Filler.** Slide the compression nut onto one end of the tubing so that just a little of the tubing extends beyond the edge of the nut. Hand-tighten the nut onto the threaded section of the Auto-Filler so that the tubing is now connected. Don't use a wrench.



\*Rubbermaid® is the trademark of Newell-Rubbermaid, Inc.